

DRAWING FOR CUSTOMER

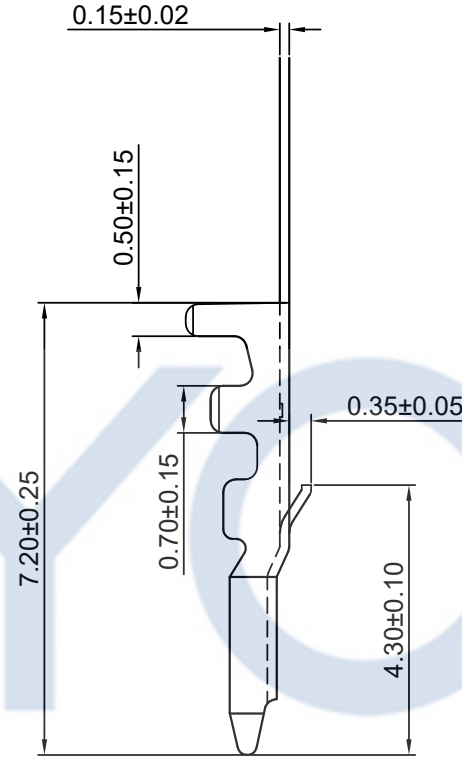
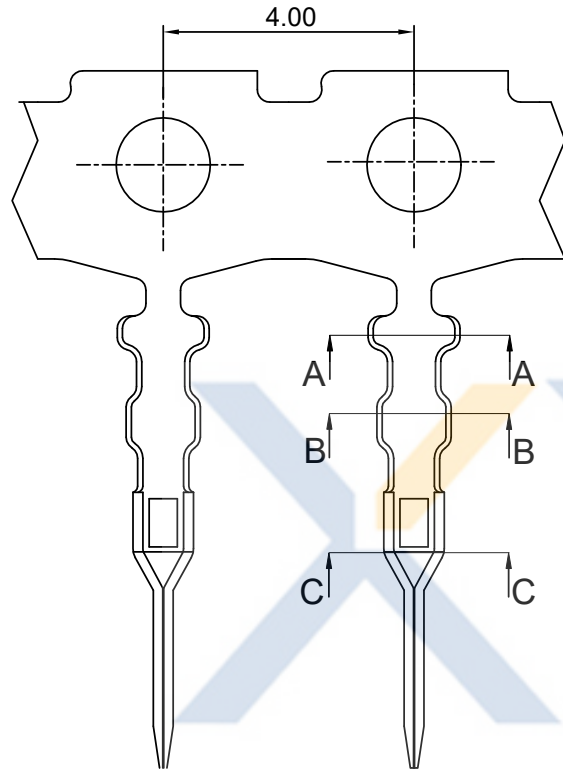

■SPEC.:

- Rated Voltage:125V AC,DC
- Rated Current:1A AC,DC
- Withstand Voltage:500V AC/minute
- Contact Resistance:20mΩ max
- Insulation Resistance:100MΩ min
- Temperature Range:-25℃~+85℃

■Terminal

- Material:Phosphor Bronze C5191
- Finish: Tin-plated;over Nickel-plated.
- Applicable wire:AWG#26~32
Insulation OD:1.0mm Max
- QTY.:20KPCS/Reel

KB915-X X T 1 A-F1

- 1:All plated
- 2:Half plated

Wire To Wire

Plating

- 0: Tin-plated
- 1: Gold Flash
- 2: Gold Plated3u"
- 3: Gold Plated5u"

Version

Mold No.

Terminal

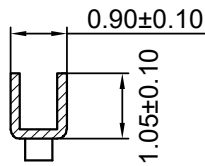

Section: C-C

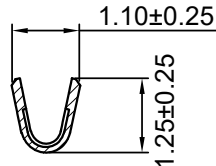

Section: B-B

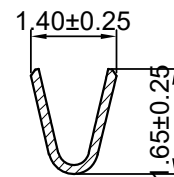

Section: A-A

XYCO 东莞市轩业电子科技有限公司
TEL: 0769-8297 9981/2/3 http://www.XYCO.com.cn

2014-07-28		A			KB915-XXT1A-F1	Devin	TOLERANCE 公差		DRAWING 設計者	Devin	KB915-XXT1A-F1	
DATE 日期	VER 版本	CHANGE HISTORY 變更歷史		CHANGED NAME 修改後料號	DRAWING 變更者		.X=±0.30	CHECKED 審查	Thomas		PART NO. 料號	UNIT 單位
							.XX=±0.20	APPROVED 核准	William		DWG NO. 圖號	mm
							.XXX=±0.10				PE3107A	PRODUCT NAME 產品名稱
												51047 PH1.25mm Wire To Wire Terminal

