

# DRAWING FOR CUSTOMER

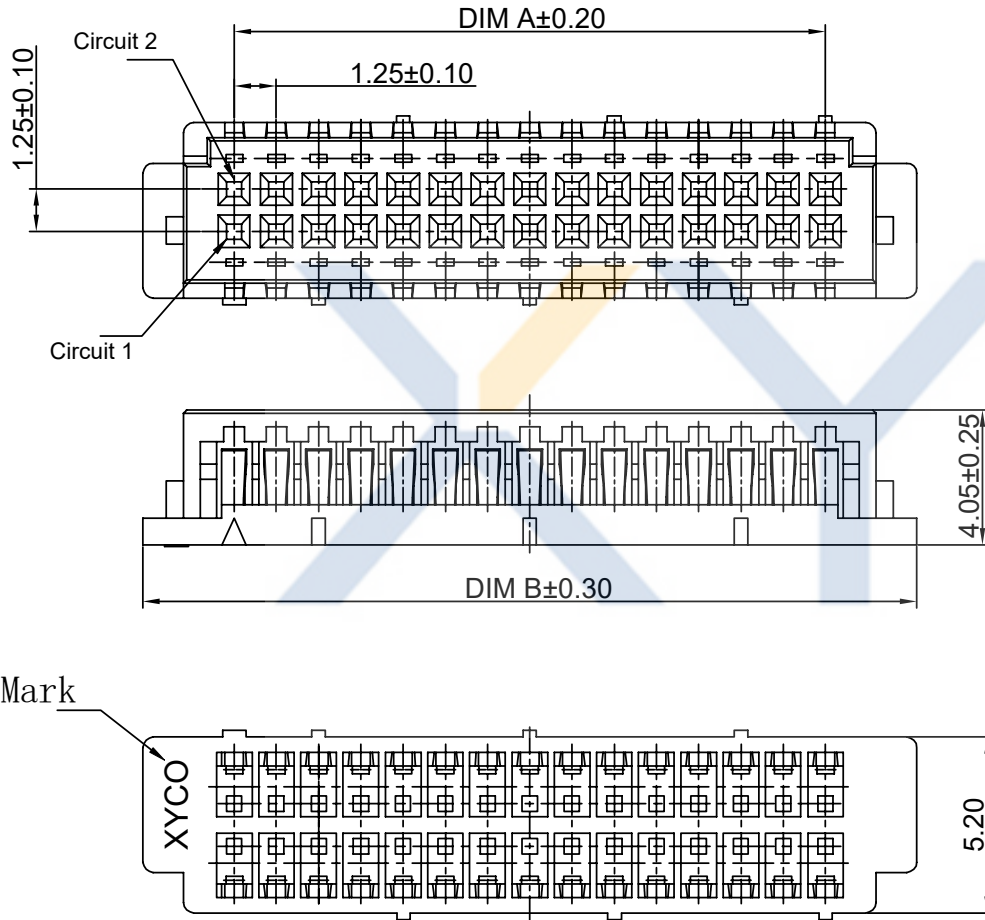

- SPEC.:
- Rated Voltage:150V AC,DC
  - Rated Current:1A AC,DC
  - Withstand Voltage:500V AC/minute
  - Contact Resistance:30mΩ max
  - Insulation Resistance:500MΩ min
  - Temperature Range:-25℃~+85℃

- Material:
- Insulator:PA66 UL94V-0

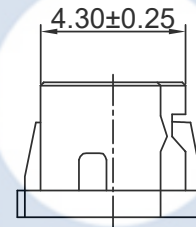

KB911-D X X H 2 A -X

Double row  
Pin No.  
Housing

XYCO  
Version  
Mold No.

Precision Connectors

Poles	Dimensions(mm)	
	A	B
2X05	5.00	10.40
2X10	11.25	16.65
2X15	17.50	22.90
2X20	23.75	29.15

**XYCO** 东莞市轩业电子科技有限公司  
TEL: 0769-8297 9981/2/3 http://www.XYCO.com.cn

2023-03-13	A1	增加LOGO(XYCO)	KB911-DXXH2A-X	Devin	TOLERANCE 公差	DRAWING 設計者	Devin	KB911-DXXH2A-X	
2013-06-21	A		KB911-DXXH2A	Devin	.X=±0.30 .XX=±0.20 .XXX=±0.10	CHECKED 審查	Thomas	PART NO. 料號	UNIT 單位
DATE 日期	VER 版本	CHANGE HISTORY 變更歷史	CHANGED NAME 修改後料號	DRAWING 變更者		APPROVED 核准	William	DWG NO. 圖號	PE2802A

mm	PRODUCT NAME 產品名稱	DF13 PH1.25mm Wire To Board Double row Housing
----	----------------------	---