

DRAWING OF FINISHED PRODUCT

KB802-XXHE1A-B1X

Pin No. XYCO
 Housing Material
 Ear Version
 Mold No.

- SPEC.:
- Rated Voltage: 30V AC,DC
 - Rated Current: 1.0A AC,DC
 - Withstand Voltage: 200V AC/minute
 - Contact Resistance: 30mΩ max
 - Insulation Resistance: 100MΩ min
 - Temperature Range: -25°C~+85°C

- Material:
- Insulator: B1-PA66 UL94V-0

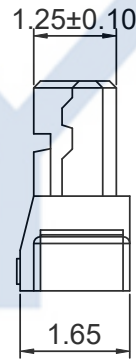
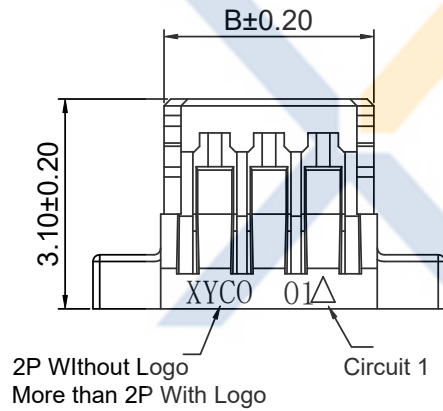
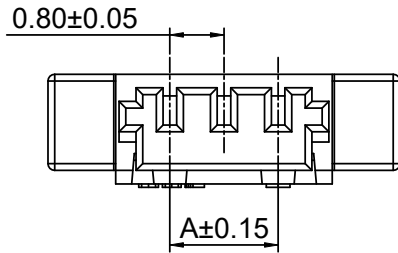

Poles	Dimensions(mm)		
	A	B	C
02	0.80	2.30	4.40
03	1.60	3.10	5.20
04	2.40	3.90	6.00
05	3.20	4.70	6.80
06	4.00	5.50	7.60
07	4.80	6.30	8.40
08	5.60	7.10	9.20
09	6.40	7.90	10.00
10	7.20	8.70	10.80
11	8.00	9.50	11.60
12	8.80	10.30	12.40
13	9.60	11.10	13.20
14	10.40	11.90	14.00
15	11.20	12.70	14.80
16	12.00	13.50	15.60
17	12.80	14.30	16.40
18	13.60	15.10	17.20
19	14.40	15.90	18.00
20	15.20	16.70	18.80

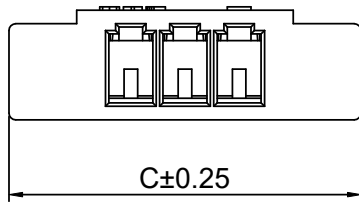

XYCO 东莞市轩业电子科技有限公司
 TEL: 0769-8297 9981/2/3 http://www.XYCO.com.cn

2016-11-25		VER	CHANGE HISTORY		CHANGED NAME	DRAWING	TOLERANCE	DRAWING	Devin	KB802-XXHE1A-B1X		UNIT	mm	PRODUCT NAME	SUH PH0.80mm Wire to Board Housing ear
DATE	日期	版本	變更歷史	修改後料號	變更者	.X=±0.30 .XX=±0.20 .XXX=±0.10	CHECKED	Thomas	PART NO. 料號	DWG NO. 圖號	PE200704A				
							APPROVED	William							